

GS16 - 1

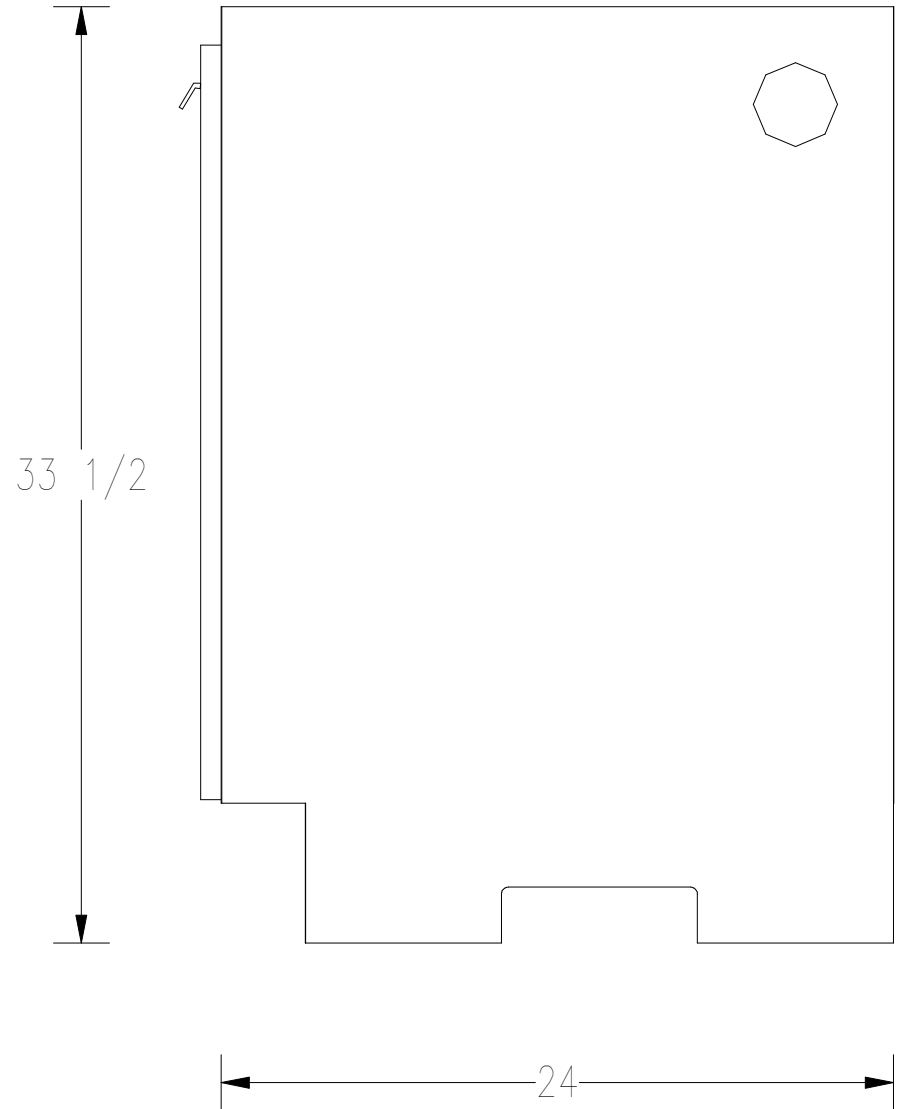
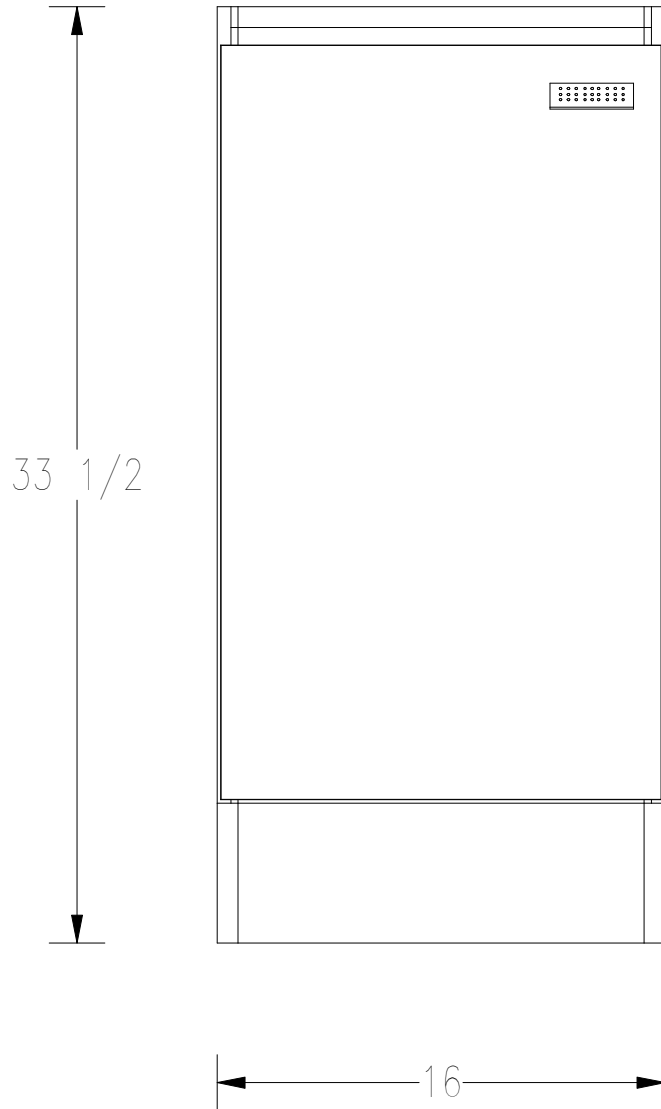

15 Elaine Drive
 Hermon, ME 04401
 p. 207-848-7770
 f. 207-848-7771
 www.bdsolid.com

B & D MODULAR CABINETS		DIMENSIONS		△	DATE	REFERENCE	SHEET #
PRODUCT NAME:	STORAGE 16□	WIDTH:	16	--	--	--	01
PRODUCT ID:	GS16 - 1	HEIGHT:	33 1/2				
PRODUCT DISCRPTION:	STORAGE 16	DEPTH:	24				
DRAWN BY:	D. PELLETIER	TOE:	HEIGHT = 5 RECESS = 3				

This drawing was prepared exclusively for you with the understanding that b&d - fabrication by design reserves the sole rights to its possession and use. Any reproduction or use of this drawing that is detrimental to our business is prohibited.

GS18 - 1

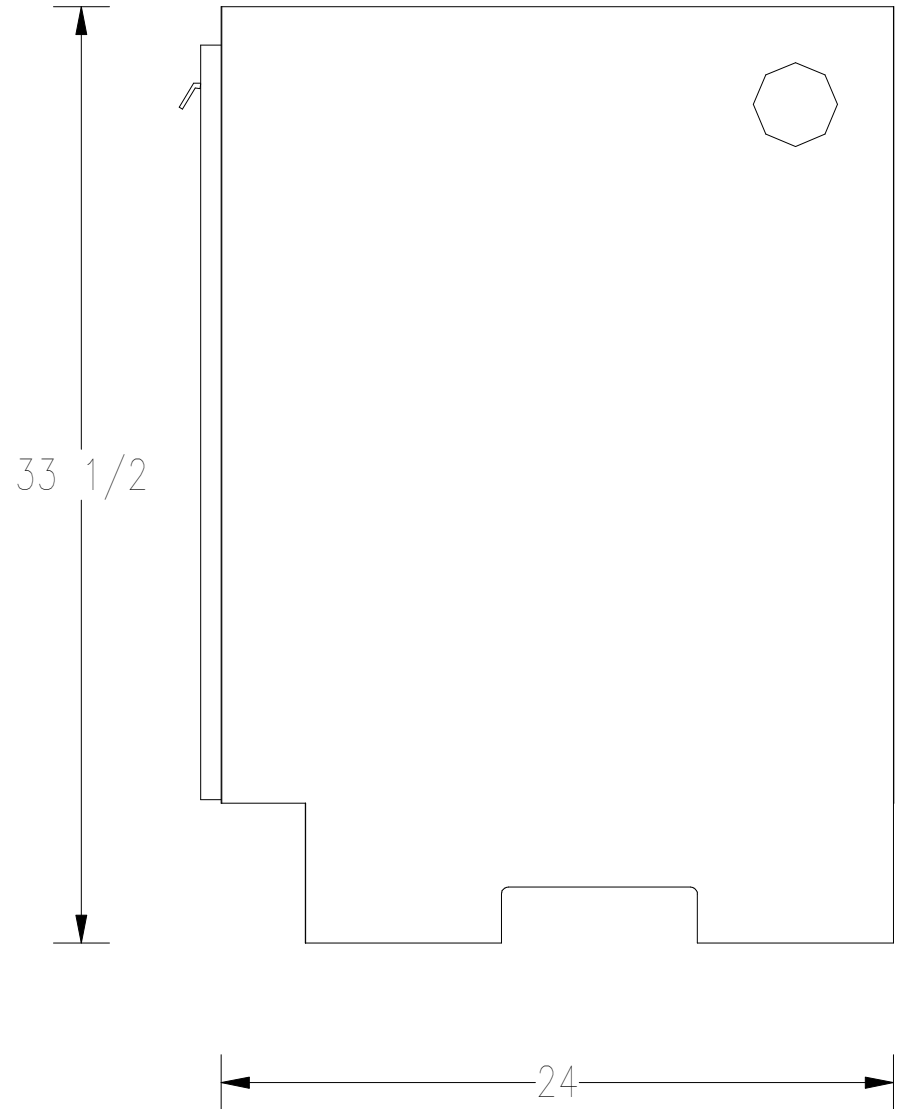
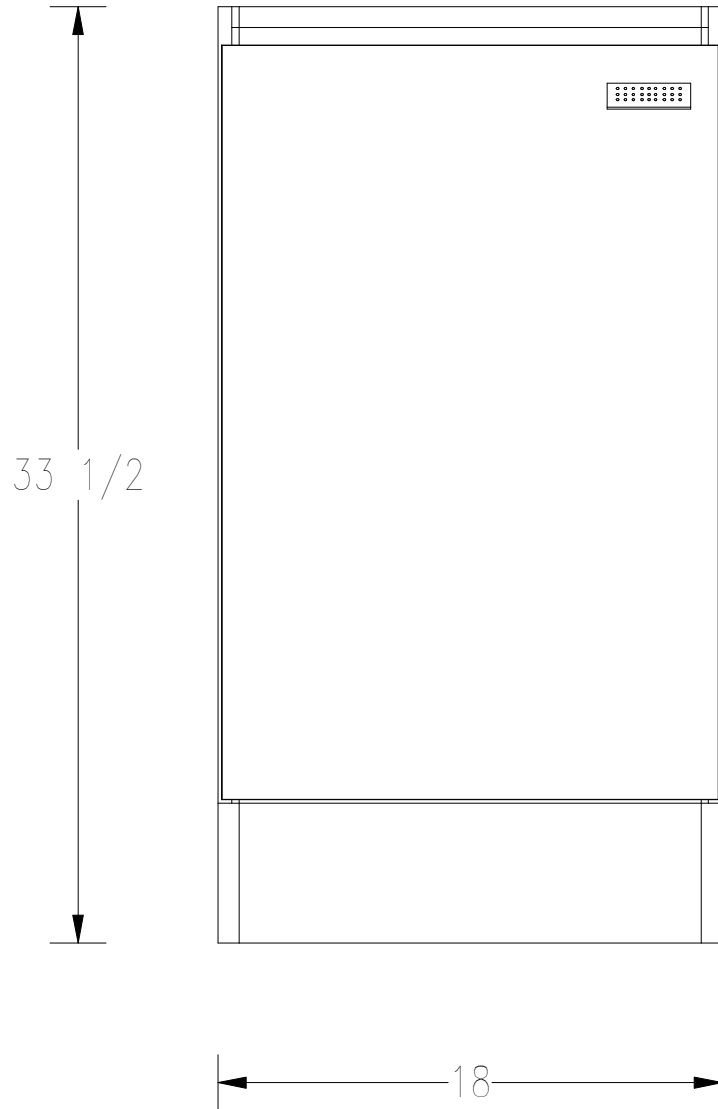

15 Elaine Drive
 Hermon, ME 04401
 p. 207-848-7770
 f. 207-848-7771
 www.bdsolid.com

B & D MODULAR CABINETS		DIMENSIONS		△	DATE	REFERENCE	SHEET #
PRODUCT NAME:	STORAGE 18□	WIDTH:	18	--	--	--	01
PRODUCT ID:	GS18 - 1	HEIGHT:	33 1/2				
PRODUCT DISCRIPTION:	STORAGE 18	DEPTH:	24				
DRAWN BY:	D. PELLETIER	TOE:	HEIGHT = 5 RECESS = 3				

This drawing was prepared exclusively for you with the understanding that b&d - fabrication by design reserves the sole rights to its possession and use. Any reproduction or use of this drawing that is detrimental to our business is prohibited.

GS20 - 1

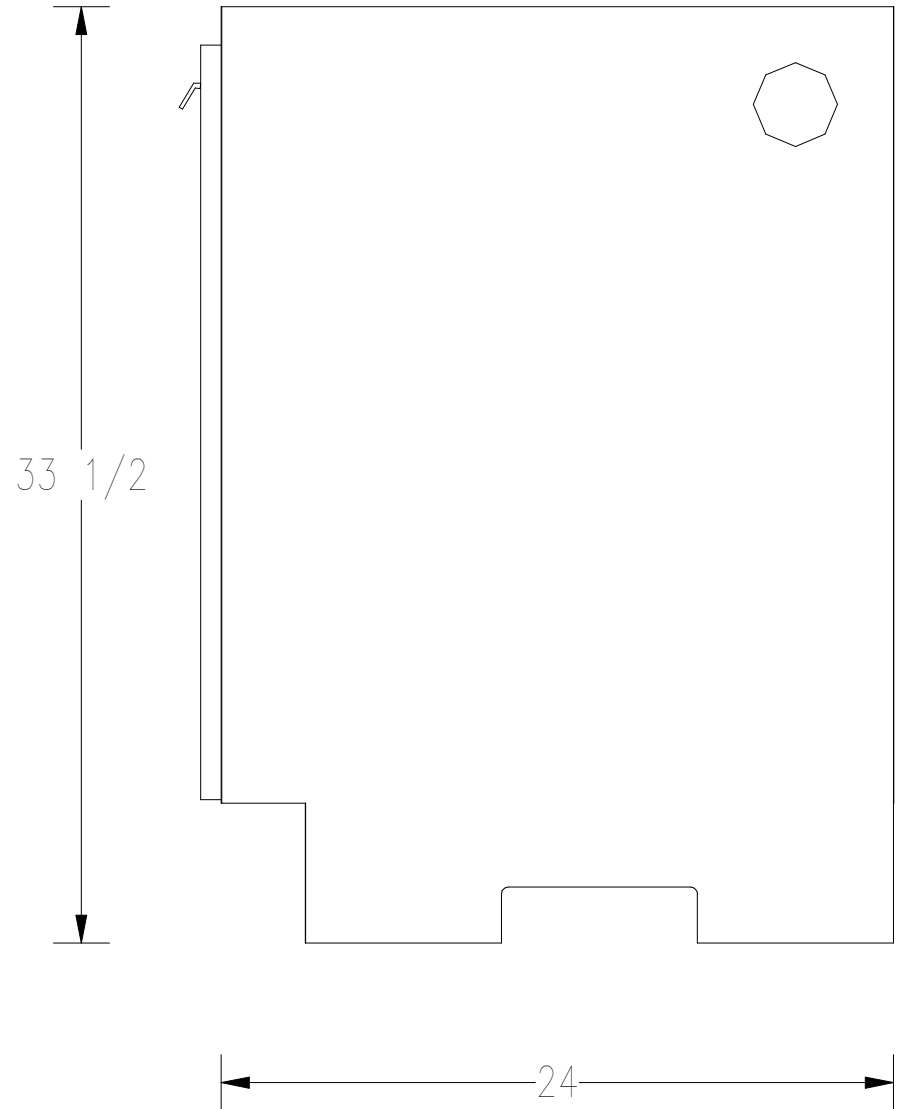
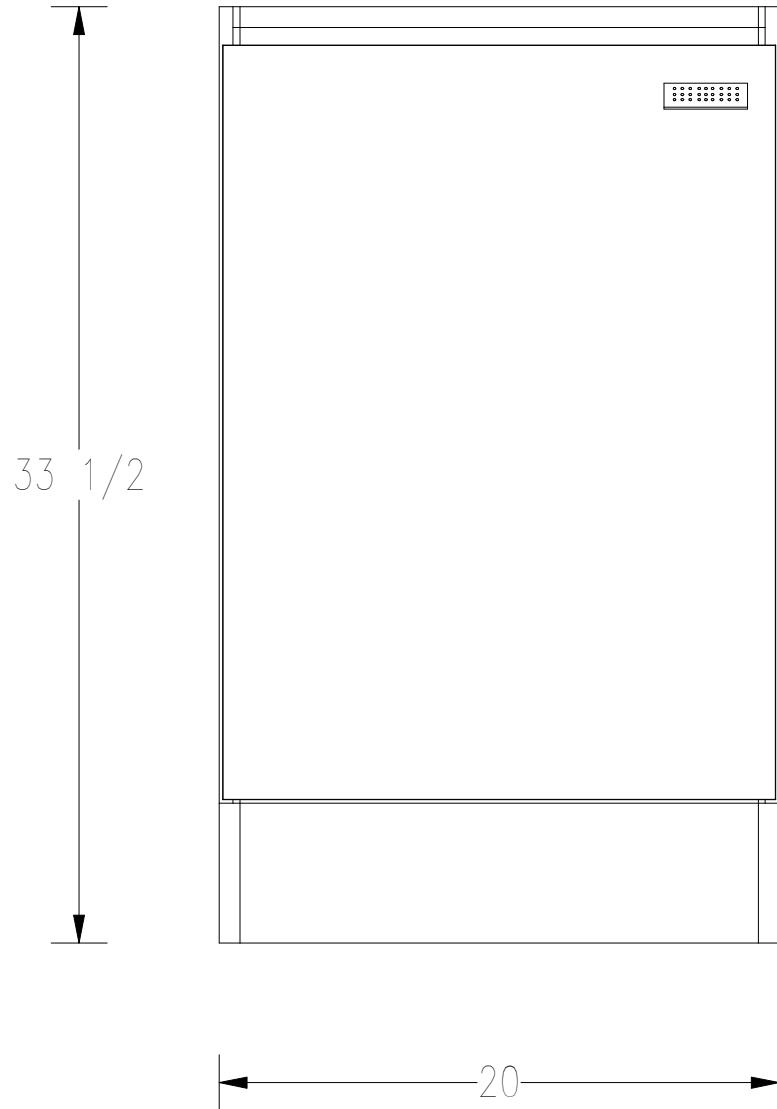

15 Elaine Drive
 Hermon, ME 04401
 p. 207-848-7770
 f. 207-848-7771
 www.bdsolid.com

B & D MODULAR CABINETS		DIMENSIONS		△	DATE	REFERENCE	SHEET #
PRODUCT NAME:	STORAGE 20□	WIDTH:	20	--	--	--	01
PRODUCT ID:	GS20 - 1	HEIGHT:	33 1/2				
PRODUCT DISCRPTION:	STORAGE 20	DEPTH:	24				
DRAWN BY:	D. PELLETIER	TOE:	HEIGHT = 5 RECESS = 3				

This drawing was prepared exclusively for you with the understanding that b&d - fabrication by design reserves the sole rights to its possession and use. Any reproduction or use of this drawing that is detrimental to our business is prohibited.